

# Release the Shackle on an iBox BT LE

Press down firmly on the shackle while supporting the iBox from the bottom.

Then pull up on the shackle to remove it completely from the iBox BT LE.

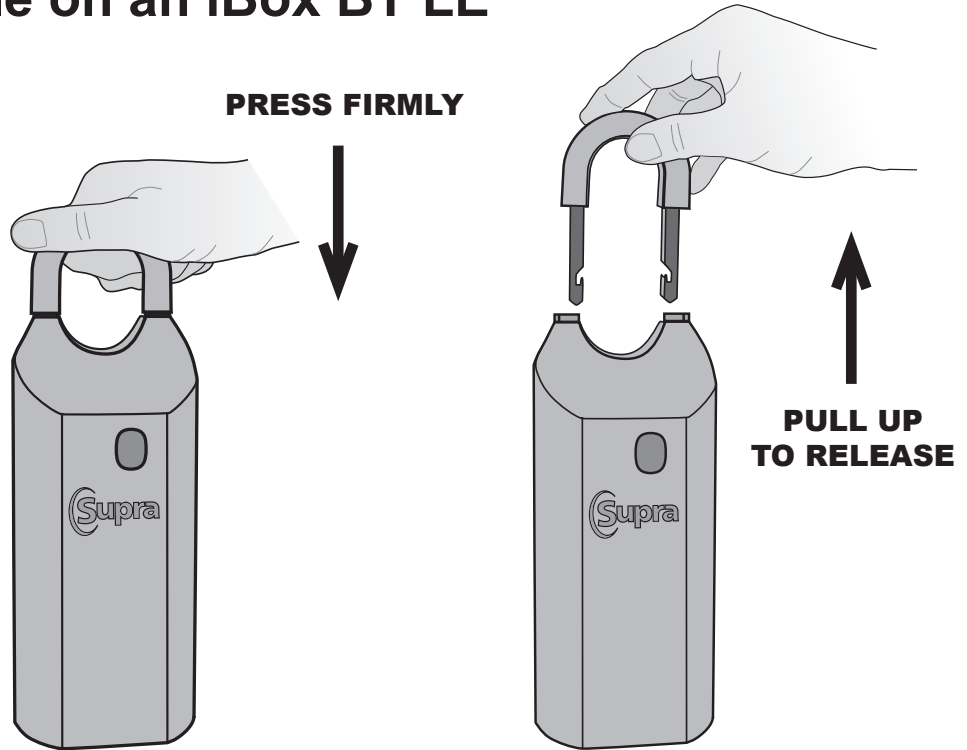

© 2014 United Technologies Corporation. All rights reserved. Other brand and product names are or may be trademarks of, and are used to identify products or services of, their respective owners.